

Checklist Signal-Lights SLE161/SLE162



Please fill out the checklist as completely as possible and send the PDF document to: info@tsl-escha.com
After checking the conformity of the checklist, you will receive a final article drawing in which the product is clearly described. In addition, you will receive an attractive offer according to your specifications. We will also be happy to complete the checklist together with you. Please call us if required: +49 2353/66796-0

The SLE16n is available as a signal light or as a direction indicator with KBA approval.
When mounting a Signal light in the upper door area, a white diffuse cover is recommended so that it is not mistakenly interpreted as illuminated by sunlight. The two-tone illuminated SLE162 is only offered with a white diffuse cover and without a side reflector.

CUSTOMER INFORMATION

Company:

Name:

Address:

Phone:

E-Mail:

Date:

Project:

Quantity:

Quantity 1. year:

Quantity 2. year

Quantity 3. year

Note:

1 APPLICATION AREA SIGNAL LIGHT

Signal Light Direction indicator (according to ECE-R6 category 5)
yellow Frontpanel and yellow LEDs, protection class IP67. **Continue with step 5**

2 COVER



red clear
red diffuse

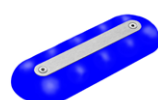

blue clear



yellow clear



white diffuse

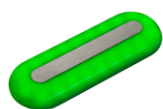

green clear



black clear

Painted metall cover: RAL tone or color tone on request

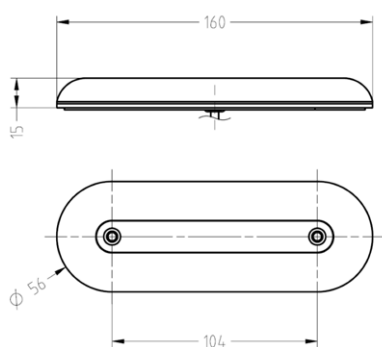

Maße ohne Toleranz in mm
Dimensions without tolerance in mm



Montageausschnitt/Mounting cutout

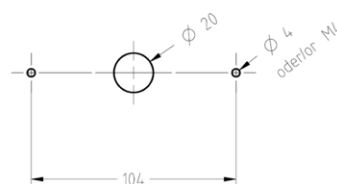

Maße ohne Toleranz in mm
Dimensions without tolerance in mm



3 DEGREE OF PROTECTION

IP67 (Fully encapsulated housing)

IP44

4 LUMINOUS COLOR

Unicolor

red yellow green blue white

Bicolor

(Only in version with 20 LEDs as SLE162, selection of white cover required)

red/green red/yellow red/white yellow/blue

Special variant on request /

5 LED QUANTITY

10 LEDs (SLE161)
Successor SLE160

20 LEDs (SLE162)

6 LIGHT-EMITTING

Direct

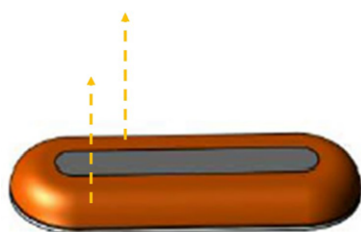

Improved lateral detection
via reflector (only possible as SLE161 with 10 LEDs and only in IP67)

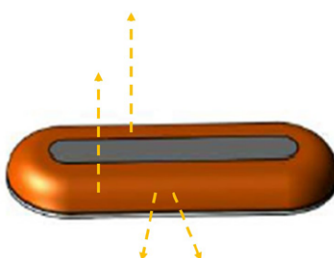

7 MOUNTING

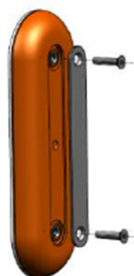

Mounting from front side
2x countersunk screws similar to DIN 7991, M4x25, A2 for screw-in depth max. 10mm

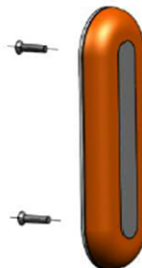

Mounting from back side
2x pan-head screws ISO 7380, M4x12, A2 for clamping range max. 6mm

8 OPTIONAL MOUNTING SCREWS

Without

With

9 GASKET

Flat gasket

- Flat seal for flat surfaces (also prevents vibration noise)
- Not visible when mounted
- Required for mounting adapter

Molded gasket

- Molded seal for textured surfaces (and to cover white bottom part with a black collar)
- Visible as a black border when mounted
- Not for mounting adapter

10 OPTIONAL MOUNTING ADAPTER

The optionally available adapter can perform the following functions:

- Replacement for luminaires from other manufacturers already in use (see drilling diagram).
- Increasing the height of the luminaire to 26mm in the installation situation
- Sealing to uneven surfaces
- Increasing the contrast to the substrate due to the black coloring

In the orders the adapter is shown separately.

Without

With

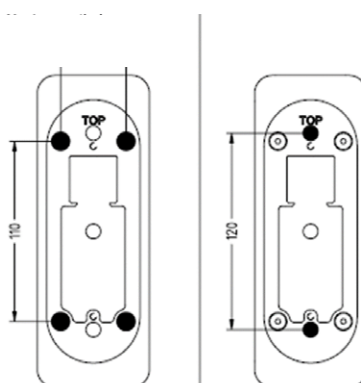

11









NOMINAL VOLTAGE

24 VDC

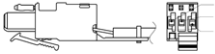
110 VDC

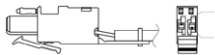
12

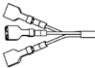
CONNECTION CABLES

64) TE Mini-Universal MATE-N-LOK, TE 794805-1 4pole (IP56/IP57)		60) ESCHA M8/Ø8 Snap (max. 60 VDC) SSFP4 4pole (IP68)	
26) WAGO 721 721-603/000-044/032-000 3pole		20) WAGO 769 769-103 3pole	
40) WAGO 721 721-602/000-044/032-000 2pole		84) WAGO 769 769-102 2pole	
63) TE Mini-Universal MATE-N-LOK 794894-1 2pole (IP56)		8S) TE ULTRAFast 250 2-520184-2, 6,3 x 0,8 mm	
8A) With wire-end sleeve		Customer specific	

13

CONNECTION LINE

(ACCORDING TO EN 45545-2 and UN/ECE R118)

L = ca. 200 mm

L = mm

PIN ASSIGNMENT

PIN	Unicolored	Bicolored
PIN 1	+UB	+UB LED1
PIN 2	GND	GND
PIN 3	-	+UB LED2
PIN 4	-	-